

TRIG-STAR PROBLEM LOCAL CONTEST

PRINT NAME: _____

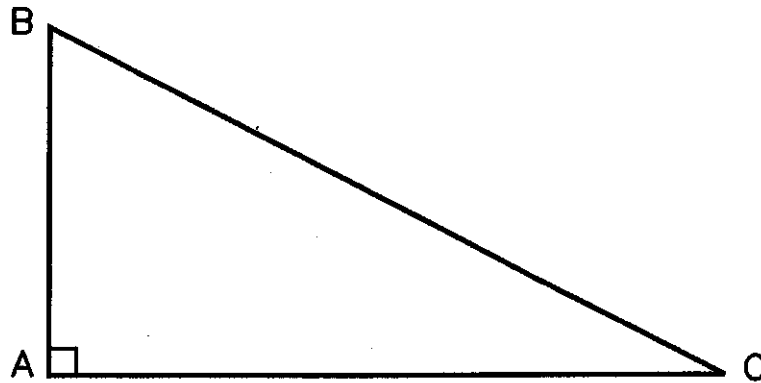

KNOWN: DISTANCE AC = 592.49 DISTANCE BC = 740.17

FIND: \angle ACB = _____ (5 POINTS)

DISTANCE AB = _____ (5 POINTS)

REQUIRED ANSWER FORMAT
 DISTANCES: NEAREST HUNDREDTH
 ANGLES: DEGREES-MINUTES-SECONDS
 TO THE NEAREST SECOND

TRIG-STAR PROBLEM LOCAL CONTEST

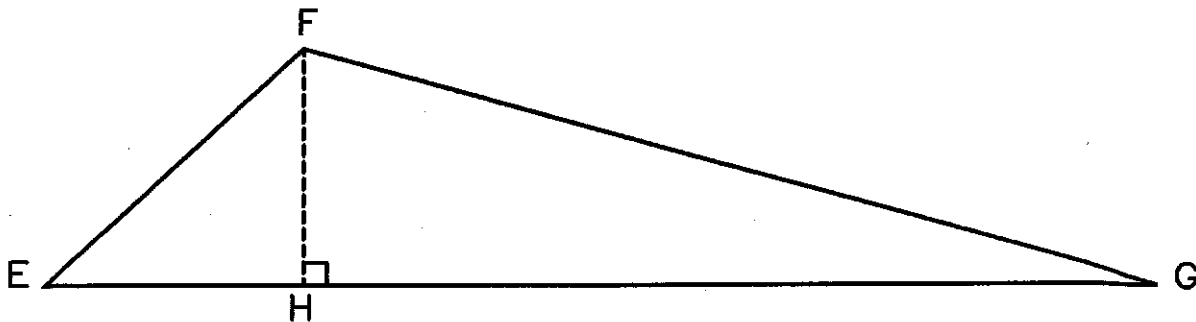

KNOWN: DISTANCE EF = 388.05 \angle EFG = 114°11'45" \angle FEG = 42°47'40"

FIND: \angle EGF = _____ (6 POINTS)

DISTANCE EH = _____ (6 POINTS)

DISTANCE FH = _____ (6 POINTS)

DISTANCE FG = _____ (6 POINTS)

DISTANCE GH = _____ (6 POINTS)

REQUIRED ANSWER FORMAT
 DISTANCES: NEAREST HUNDREDTH
 ANGLES: DEGREES-MINUTES-SECONDS
 TO THE NEAREST SECOND

PAGE TOTAL: _____ POINTS

TRIG-STAR PROBLEM LOCAL CONTEST

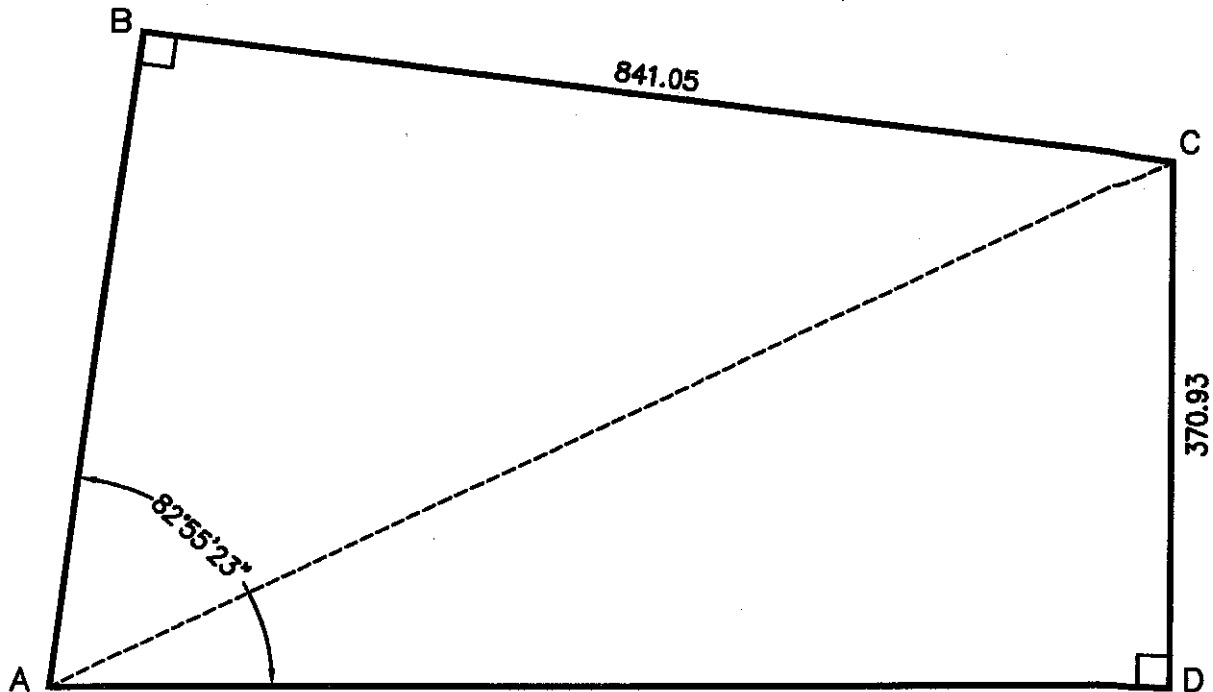

KNOWN: DISTANCE BC = 841.05 DISTANCE CD = 370.93
 $\angle BAD = 82^{\circ}55'23''$

- FIND: DISTANCE AB = _____ (10 POINTS)
DISTANCE AD = _____ (10 POINTS)
DISTANCE AC = _____ (10 POINTS)

REQUIRED ANSWER FORMAT
DISTANCES: NEAREST HUNDREDTH

PAGE TOTAL: _____ POINTS

TRIG-STAR ANSWER KEY LOCAL CONTEST

PAGE 1

$$\sphericalangle ACB = 27^{\circ}51'33''$$

$$\text{DISTANCE AB} = 201.51$$

PAGE 1

$$\sphericalangle EGF = 16^{\circ}38'16''$$

$$\text{DISTANCE EH} = 144.02$$

$$\text{DISTANCE FH} = 128.94$$

$$\text{DISTANCE FG} = 450.34$$

$$\text{DISTANCE GH} = 431.48$$

PAGE 2

$$\text{DISTANCE AB} = 322.59$$

$$\text{DISTANCE AD} = 544.47$$

$$\text{DISTANCE AC} = 603.92$$

PAGE 3

$$\text{DISTANCE DA} = 121.90$$

$$\text{DISTANCE FC} = 89.47$$

$$\text{DISTANCE DC} = 123.78$$

$$\sphericalangle BFC = 79^{\circ}58'42''$$

$$\text{AREA ABCD} = 15,287$$